

Terminal valve STVT



Areas of use

Terminal valve STVT is used to balance and regulate heating- and cooling systems.

Description

STVT is a balancing and regulating valve. The valve is equipped with self-sealing measuring ports, placed at a 45° angle in relation to the line centre. Pre-setting can be carried out using the pre-setting key FN2 by opening a number of turns from shut position as shown on the pressure drop diagram (see next page).

STVT comes with male or female connection, 1/2" or 3/4". STVT should be regulated by electro-thermal actuators type VMC/VMO with M28x1,5 connection.



Technical data

Pressure class

PN 16

Max temperature

120°C

Min temperature

-20°C

Max closing pressure

200 kPa

Min measured pressuredrop

5 kPa

Recommended pressure drop at rated valve

5-10 kPa

Kv-value (pre-set) with actuator

DN15 0,01 2,15

DN20 0,01 - 2,80

Material

Dezincification resistance brass

Gaskets EPDM

Dimensions

	Dim	A	B	C	Weight /kg
STVT 15	15	86	41	50	0,388
STVT 20	20	86	41	50	0,450
STVT 15i	15	86	41	50	0,388
STVT 20i	20	88	43	50	0,450

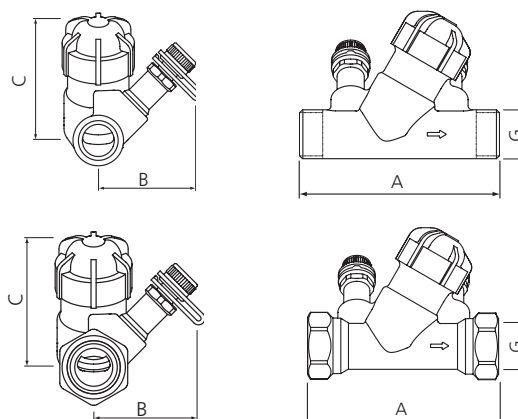

Pre-setting FN2 key

The valves are equipped with a insert with concealed pre-setting.

Setting can be done with the FN2 tool by turning the number of turns as shown in the pressure drop diagram to the left.

To simplify this process use the scale with a pre-setting diagramm.

Pre-setting FV10

Dismantle the stuffing box with the push rod (use the top of pre-setting key FN2).

- Place the pre-setting key with the bordered end down in the pre-setting sleeve and close the valve by turning it carefully to the bottom (clockwise).
- Remove the pre-setting key and mount the pre-setting tool (FV10) over the insert splines and insert the pre-setting key through the tool.
- Reset the scale to the index marker.
- Adjust the pre-setting sleeve (counter clockwise) so that the desired k_V value coincides with the index marker.
- Pre-setting can also be done with the pre-setting key FN2 by turning it upwards the number of turns stated in the diagram for required k_V value.
- Assemble the stuffing box with the push rod.

Installation

To avoid turbulence which can affect the measuring accuracy the valve should not be mounted close to bends, branch lines and other valves directly before or after the valve according to the figure.

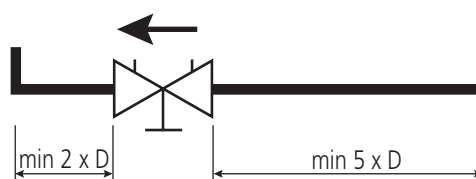

Ordering codes

RSK no.	Art.no.	Name	Description
489 27 00	3254501	STVT 15	G15 male threads
489 27 01	3254601	STVT 20	G20 male threads
489 27 10	3255801	STVT 15i	G15 female threads
489 27 11	3255901	STVT 20i	G20 female threads

We reserve the right to alter information without notice

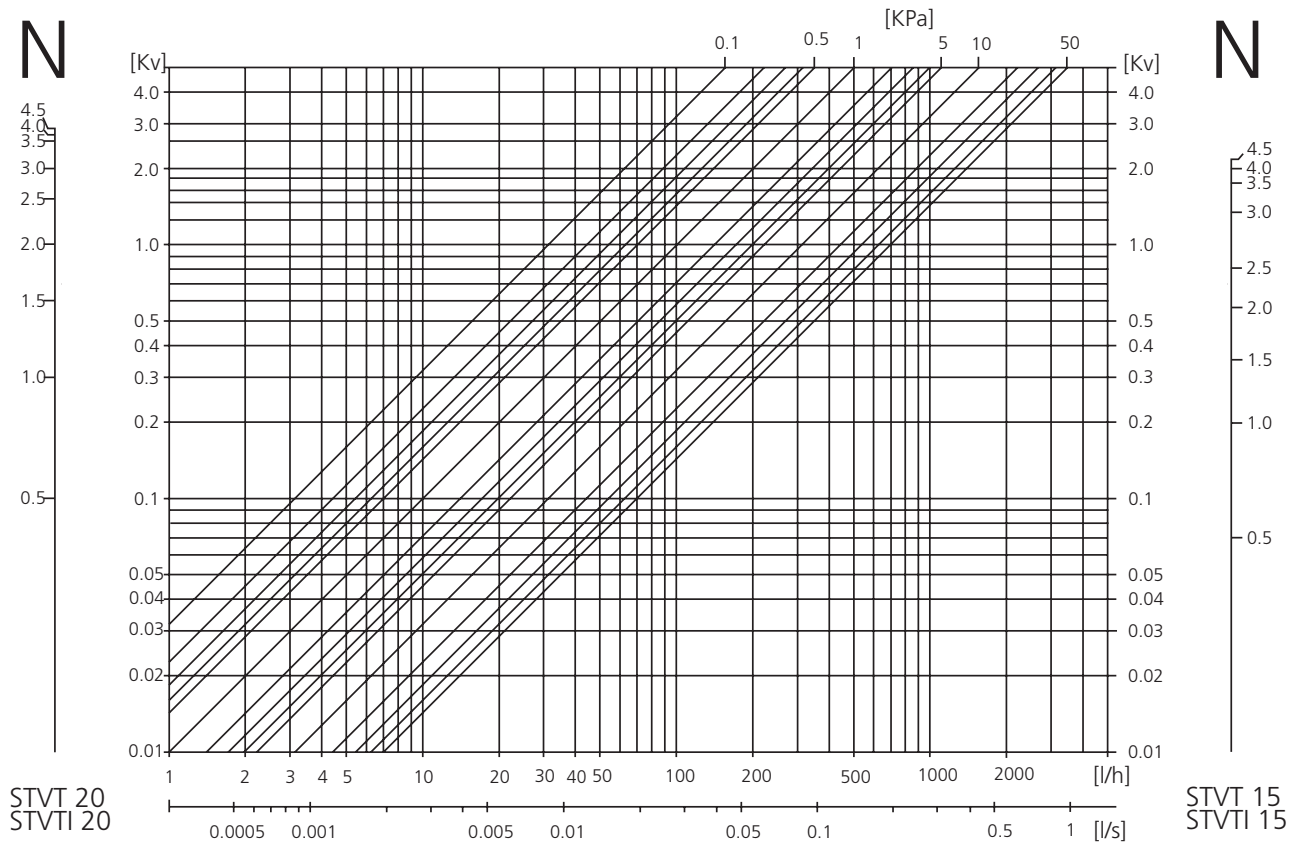

We recommend a pressure drop at 5-10 kPa at rated valve.