

S-1140/S-1240 Resilient seat gate valve DN 400/500

Serienr 02-04

Application and features

- Application: Drinking water
- Design pressure 48 bar
- Flexible solutions for manoeuvring
- Prepared for automation (electric motor, indication)
- Water lubricated sleeve bearings to reduce operation torque
- 1/4" manual bonnet air relief valve
- Replacable wedge guiding rails in non-corroding material (6 pieces) to prevent damage to rubber and surface treatment
- Service outlets (optional)
- DN 500 equals DN 400, with additional two pieces of 500 x 400 flanged reducers
- Clockwise closing
- GSK approved coating



Technical description

- Design standards: EN 1171, EN 1984, EN 12516-2, ISO 7259, EN 1074, EN 545
- Face-to-face length S-1140: EN558/ ISO 5752 series 14
- Face-to-face length S-1240: EN558/ ISO 5752 series 15
- Max. working pressure: PN 16, vacuum -0,8 bar
- Flange drilling: Standard drilling PN 10 (EN1092-2), PN 16 on request
- Max. temperature: 50°
- Test pressure open valve: 24 bar
- Test pressure closed valve: 21 bar
- Coating: Epoxy minimum 250 µm
- Body/bonnet connection: Socket head bolts covered with wax
- Valve top: Prepared for spindle extension S-1880
- Stem: Non-rising with tapered stem end, according to DIN 87303(see table)
- Coating: Epoxy according to DIN 3476 and DIN 30677-2
Colour: Blue, RAL 5017
- GSK standard: RAL - GZ 662

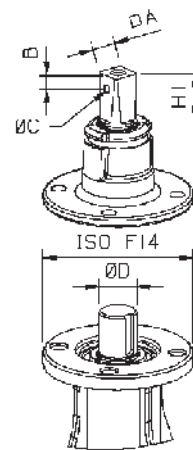

Dimensions stem top:

DN 400	
A	32,3
B	16
C	8
D	44
H1	55
H2	51

References and dimensions

Series	DN mm	Flange-drilling	H mm	L mm		Kv m ³ /h	Z	Esco no.
S-1140	400	PN 10	1053	310	285	16359	0,15	11400400
	400	PN 16	1053	310	285	16359	0,15	11400401
S-1240	400	PN 10	1053	600	443	16359	0,15	12400400
	400	PN 16	1053	600	443	16359	0,15	12400401
	500*	PN 10	1053	700	450	25562	0,15	12400500
	500*	PN 16	1053	700	450	25562	0,15	12400501

* 400 valve with increasing flange

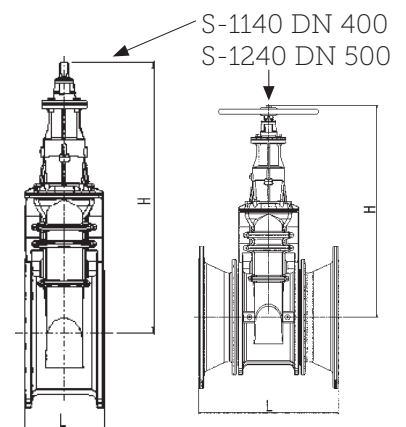

Ulefos Esco AS can accept no responsibility for possible errors in catalogues, brochures and other printed material. Ulefos Esco AS reserves the right to alter its products without notice. This also applies to products already on order provided that such alterations can be made without subsequential changes being necessary in specifications already agreed. All trademarks in this material are property of the respective companies. Ulefos Esco AS and the Ulefos Esco AS logotype are trademarks of Ulefos Esco AS. All rights reserved.

S-1140/S-1240 Resilient seat gate valve DN 400/500

Serienr. 02-04

Material specification

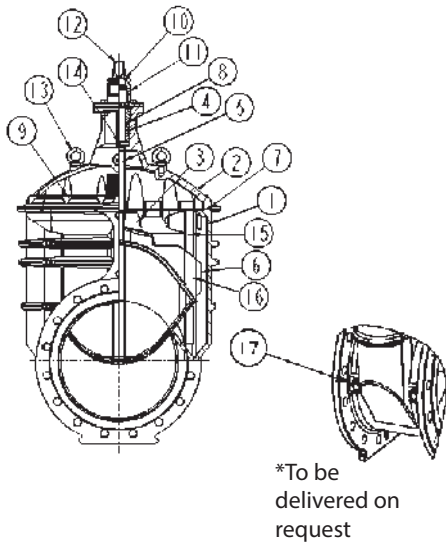

Pos	Detail	Materials
1	Body	Ductile iron EN 1563 EN-GJS-500-7
2	Bonnet	Ductile iron EN 1563 EN-GJS-500-7
3	Stem nut	Dezinkfree brass (DZR)
4	Stem bushing	Dezinkfree brass (DZR)
5	Stem	Stainless steel EN10088-3 1.4021
6	Wedge	Ductile iron EN1563 EN-GJS-500-7, EPDM
7	Gasket	Rubber EPDM
8	O-rings	Rubber EPDM
9	Socket head bolt	Steel 8.8
10	Dirt seal	Rubber (NBR)
11	Adapter	Ductile iron EN 1563 EN-GJS-500-7
12	Stem top	Stainless steel EN10088-3 1.4021
13	Lifting lug	Steel 8.8
14	Sleeve bearing	Composite
15	Guiding rail	Brass CC333G-GZ/GC
16	Guiding chip	Peek
*17	Service outlet 1" (optional)	Brass
18	Air relief valve	Dezinkfree brass (DZR)

Characteristics

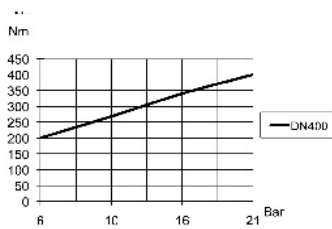

Operating torque

DN	No. of turns	Bore in mm	Max allowed operating torque
400	59	406	500 Nm
500	59	406	500 Nm

If the valve does not close at max torque check out for possible errors !

Additional equipment

- S-1110 Handwheel
- S-1112 Handwheel extension L=250 (DN 100)
- S-1112 Handwheel extension L=265 (DN 150)

- S-1880 Spindle extension
- S-1880-0 Operating tool bar
- S-1830/S-1835/S-1840 Operating box

Installation

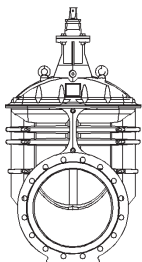

Recommended

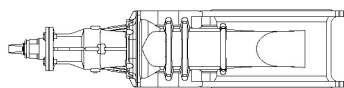

Possible



Possible

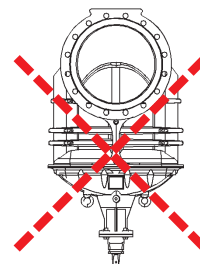

Not recommended