

# S-1140/S-1240 Resilient seat gate valve DN 80-150

Serienr 02-02

## Application and features

- Application: Drinking water
- Design pressure 64 bar
- Clockwise closing
- Blow-out proof bonnet gasket
- Lockable bayonet coupling system for spindle extension
- GSK approved epoxy coating



## Technical description

- Standards: EN 1171, EN 1984, EN 12516-2, ISO 7259, EN 1074, EN 545
- Face-to-face length S-1140: NS-EN 558/ ISO 5752 series 14
- Face-to-face length S-1240: NS-EN 558/ ISO 5752 series 15
- Max. working pressure: PN16, vacuum -0,8 bar
- Flange drilling: Standard drilling PN 10 (EN1092-2)
- Max. temperature: 50°C
- Test pressure open valve: 24 bar
- Test pressure closed valve: 21 bar
- Valve top: Prepared for spindle extension S-1880
- Stem: Non-rising with tapered stem end, according to DIN 87303 (see table)
- Bonnet connection: Socket head bolt, recessed and covered with wax
- Stem: Non-rising. With tapered stem end according to DIN 87303
- Coating: Epoxy according to DIN 3476 and DIN 30677-2  
Colour: Blue, RAL 5017
- GSK standard: RAL - GZ 662

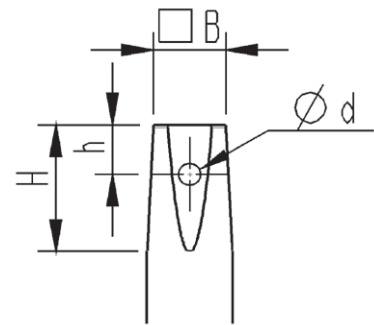

Dimensions stem top:

DN	B	H	h	d
80-150	19,3	38	17	7

## References and dimensions

Series	DN mm	H mm	L mm	Weight kg	Kv m <sup>3</sup> /h	Z	Esco no.
S-1140	80	339	180	22	567	0,2	11400080
	100	330	190	23	885	0,2	11400100
	125	430	200	33	1384	0,2	11400125
	150	430	210	38	2301	0,15	11400150
S-1240	80	330	280	23	567	0,2	12400080
	100	330	300	25	885	0,2	12400100
	125	430	325	33	1384	0,2	12400125
	150	430	350	42	2301	0,15	12400150

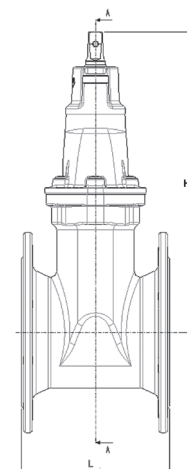

Ulefos Esco AS can accept no responsibility for possible errors in catalogues, brochures and other printed material. Ulefos Esco AS reserves the right to alter its products without notice. This also applies to products already on order provided that such alterations can be made without subsequential changes being necessary in specifications already agreed. All trademarks in this material are property of the respective companies. Ulefos Esco AS and the Ulefos Esco AS logotype are trademarks of Ulefos Esco AS. All rights reserved.

# S-1140/S-1240 Resilient seat gate valve DN 80-150

Serienr. 02-02

## Material specification

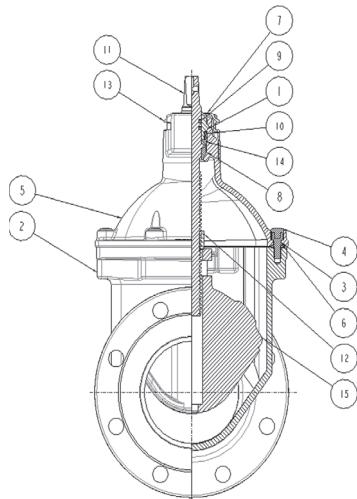

Pos	Details	Materials
1	Bayonet	Dezincification resistant brass CW602N
2	Body	Ductile iron, EN1563 EN-GJS-500-7
3	Socket head bolt	Steel 8.8
4	Wax	
5	Bonnet	Ductile iron, EN1563 EN-GJS-500-7
6	Bonnet gasket	Rubber EPDM, Forsheda
7	Sticker	CW/CCW
8	Lower bearing	POM-C
9	Spindle o-ring	Rubber EPDM
10	Bayonet o-ring	Rubber EPDM
11	Spindle	Stainless steel EN 10088-3 1.4021
12	Stem nut	RG5
13	Plastic cap	POM-C
14	Upper bearing	POM -C
15	Wedge	Ductile iron EN1563 EN-GJS-500-7, EPDM

## Characteristics

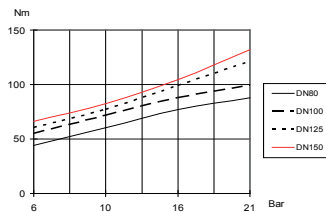

DN	No of turns	Bore dia	Max allowed torque
80	22	87	120 Nm
100	22	97	150 Nm
125	31	125	200 Nm
150	32	140	225Nm

If the valve does not close at max torque pls. check for possible errors

## Additional equipment

S-1110 Handwheel  
 S-1112 Handwheel extension L=250 (DN 100)  
 S-1112 Handwheel extension L=265 (DN 150)

S-1880 Spindle extension  
 S-1880-0 Operating tool bar  
 S-1830/S-1835/S-1840 Operating box

## Installation

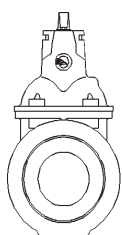

Recommended

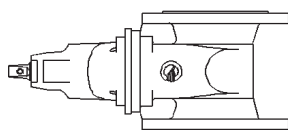

Possible

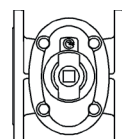

Possible

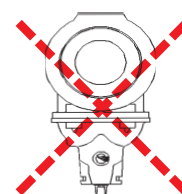

Not recommended